



**SAWE**  
CANADA CHAPTER



**May 2017**

**76th International Conference  
on Mass Properties Engineering**

**Montreal, Canada**







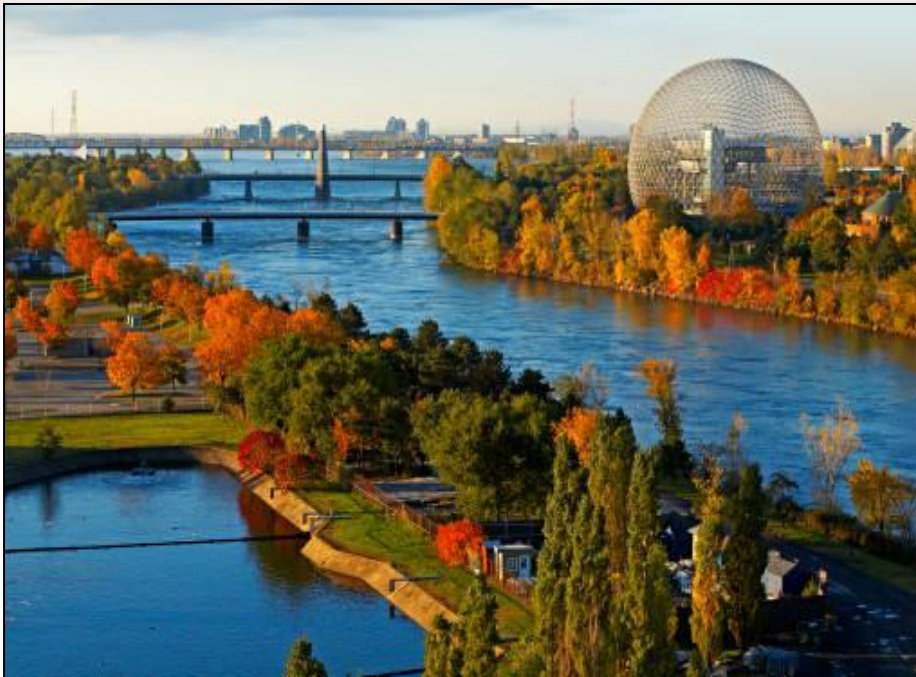

## 2017 Conference – Montreal, Quebec

- **Conference Dates : *May 20-24, 2017***
- **Venue : *Hotel Omni Mont-Royal***

### ***Conference Committee***

<b>2017 Conference Committee Positions</b>	
<b>Co-Chairmen</b>	<b>Whidy Kiskunas, Robert Hargrave</b>
<b>Publicity</b>	<b>Martyn Clarke, George Shpati</b>
<b>Technical Papers</b>	<b>Whidy Kiskunas, Tony Vella</b>
<b>Vendors</b>	<b>Rod vanDyk, David Stansfield</b>
<b>Budget</b>	<b>April Tang, Edwin Orbegoso</b>
<b>Facilities</b>	<b>Kathy Lacroix, Stuart Norris</b>
<b>Registration</b>	<b>Jerry Ramos, Cviko Vidakovic</b>
<b>Training</b>	<b>Anthony Lyczko, Charles Roux</b>
<b>Transportation</b>	<b>Paul Newsham, Kathy Lacroix</b>
<b>Special Events</b>	<b>Paul Newsham, Stuart Norris</b>
<b>Program</b>	<b>David Stansfield, Rod vanDyk</b>
<b>Photography</b>	<b>Nicolas Riou, Robert Hargrave</b>
<b>Event Coordinator</b>	<b>Paul Newsham, Stuart Norris</b>
<b>Hospitality</b>	<b>Stuart Norris, Paul Newsham</b>
<b>Website</b>	<b>Rod vanDyk</b>





# 2017 Conference - Location

**Hotel Omni Mont-Royal**  
1050 Sherbrooke Street West, Montreal, Quebec, H3A 2R6

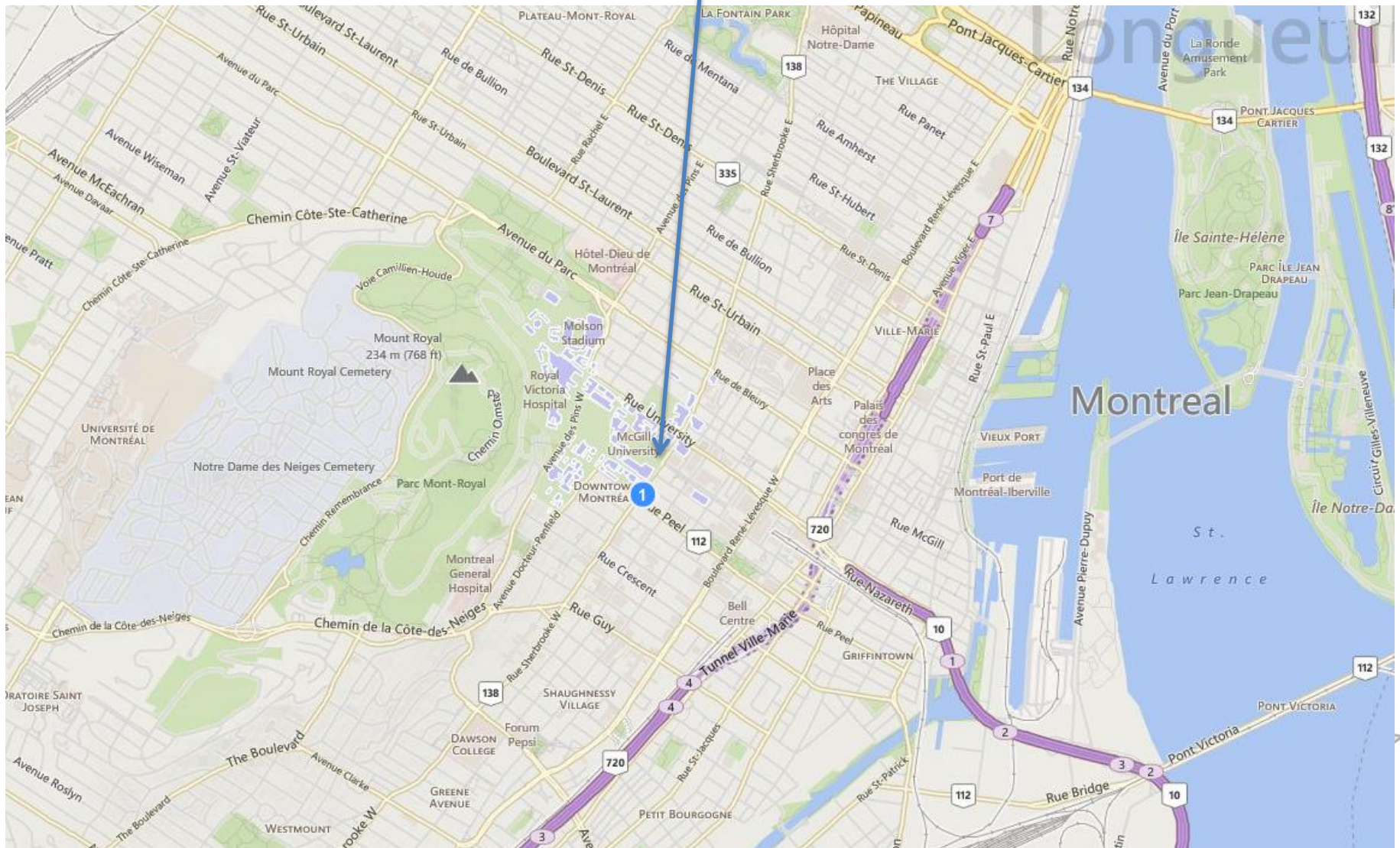



# 2017 Conference – Hotel Omni Mont-Royal

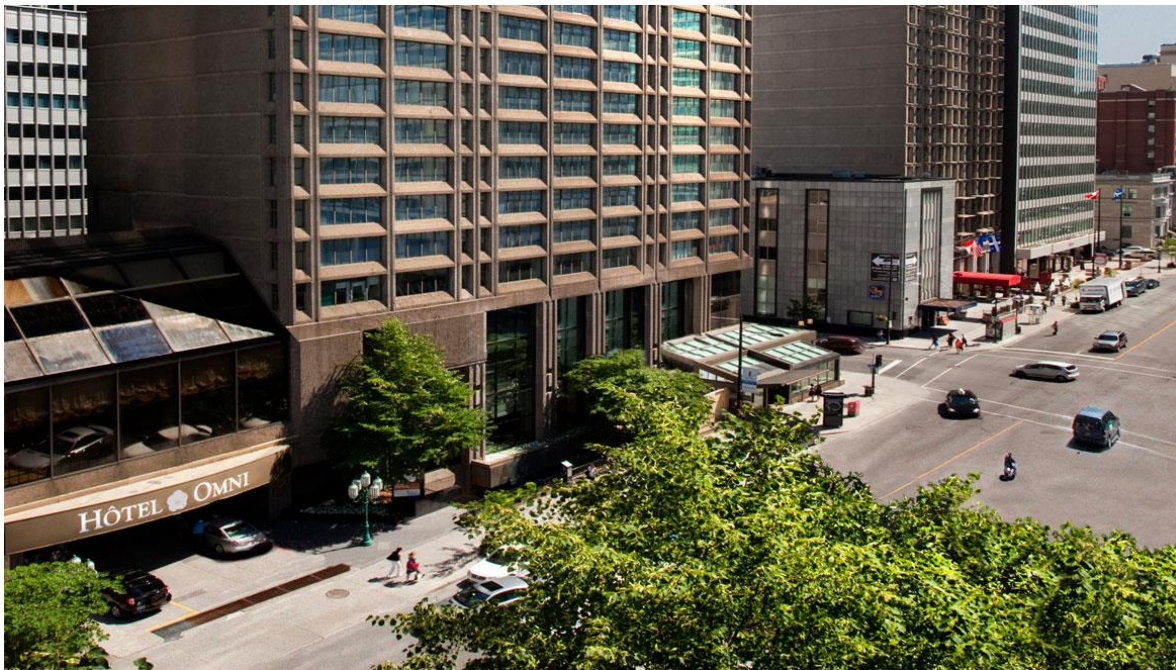



# 2017 Conference – Hotel Omni Mont-Royal

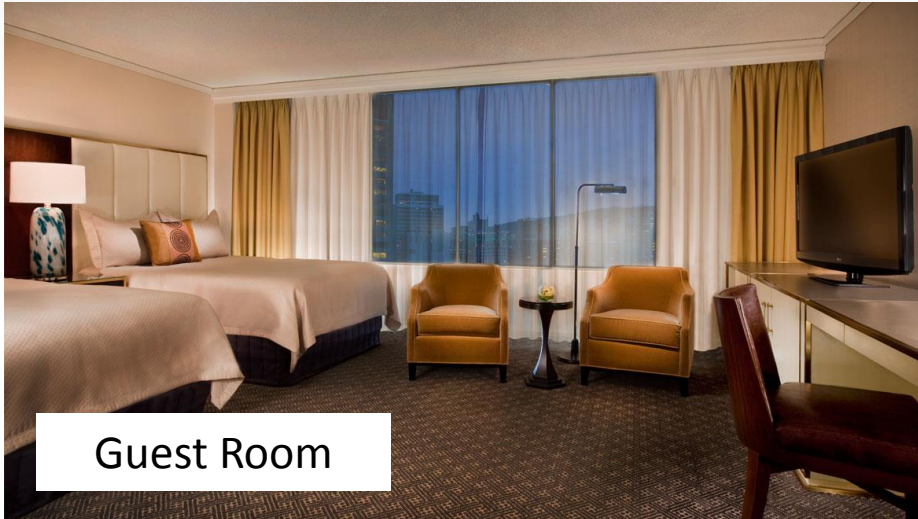

Guest Room

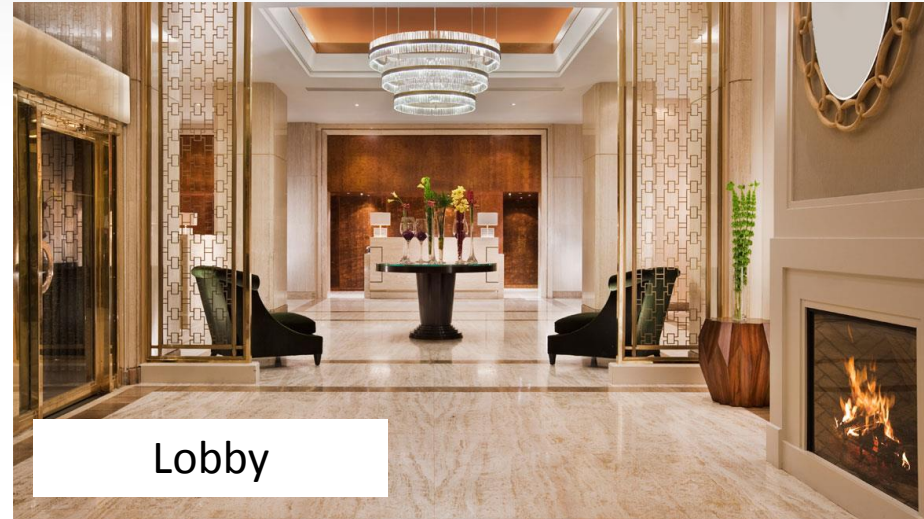

Lobby



Banquet Room

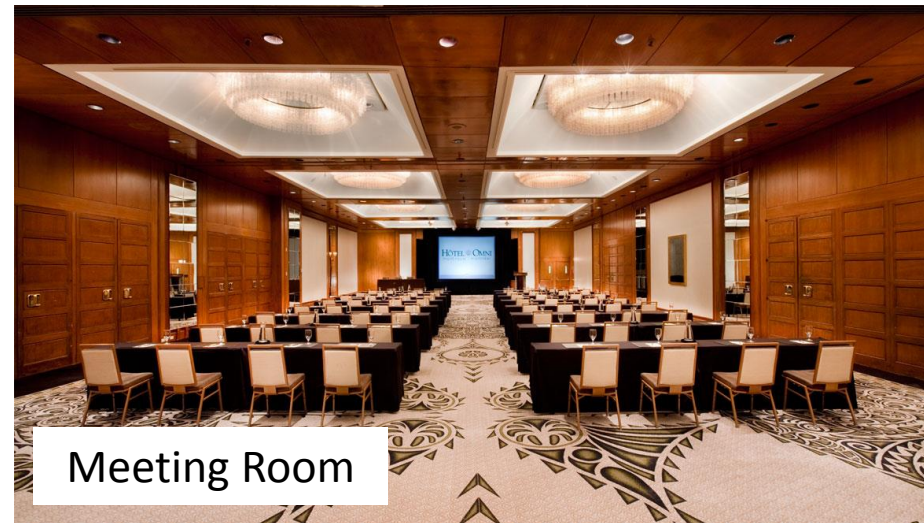

Meeting Room



# 2017 Conference – Hotel Omni Mont-Royal – Downtown Location

## Arts & Culture

- McCord Museum of Canadian history – 350 metres
- Museum of Fine Arts – 500 metres
- Contemporary Art Museum – 1.3 km
- Canadian Center for Architecture – 1.7 km
- Pointe-à-Callières Museum of Archaeology – 2.8 km

## Attractions





- Chinatown – 1 km
- Bell Centre – 1.2 km
- **Old Montreal and the Old Port** – 2.4 km
- **Notre-Dame Basilica** – 2.4 km
- **Atwater Market** – 3.1 km
- **Montreal Science Center and IMAX Theatre** – 3.5 km
- Montreal Casino – 6.8 km
- **Biodome, Botanical Gardens and Insectarium** – 8.4 km
- Olympic Tower – 8.4 km

## Nearby Dining

- Cavalli (Italian)
- Ferreira Café (Portuguese)
- L'Orchidée de Chine (Chinese)
- Shodan (Japanese)
- Europea (French)
- RISTORANTE BEATRICE (BICE) (Californian/Italian)
- Da Vinci (Italian)
- Molivos (seafood)
- Chez la Mère Michel (French)
- Buonanotte (Italian)
- Gibby's (steak house)
- Queue de cheval (steak house)





-  Office
-  Hospitality
-  Exhibits/Vendors
-  Classrooms
-  Meetings
-  Lunch/Dinner
-  Reception

## FIRST FLOOR

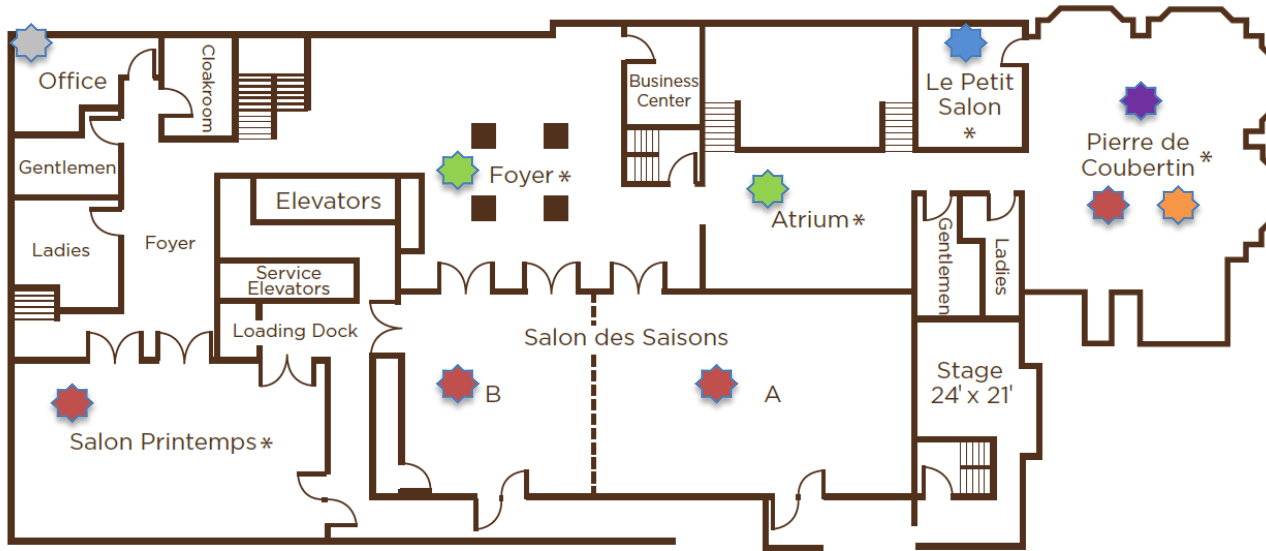

## SECOND FLOOR

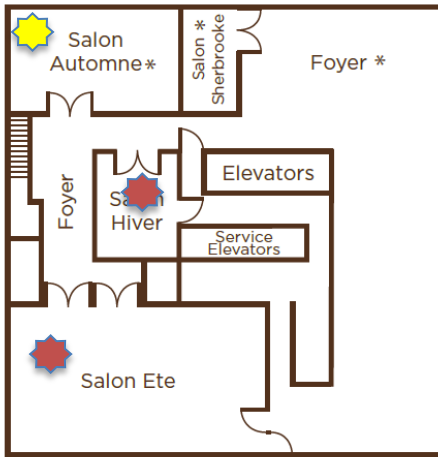

## THIRD FLOOR

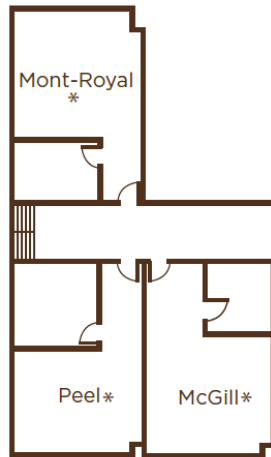

## LOWER LEVEL I

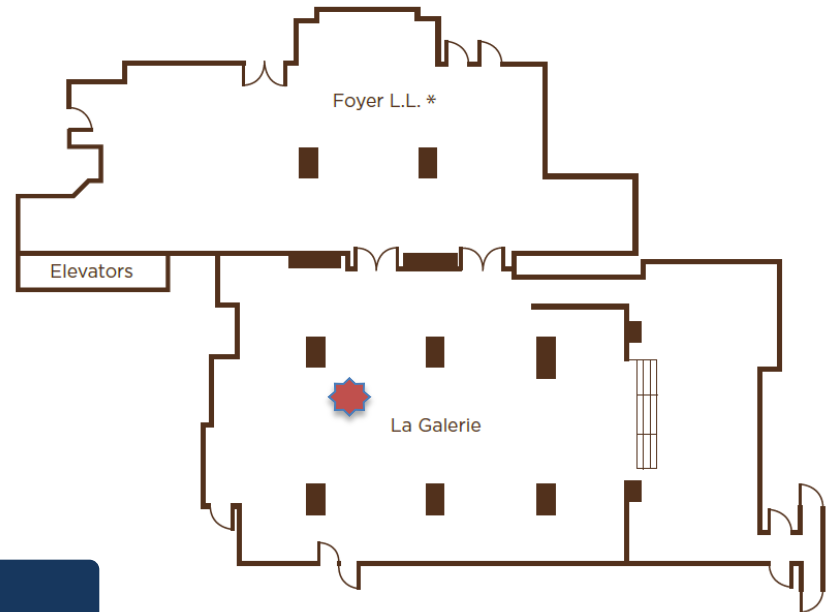

\* Natural Light







# 2017 Conference - Transportation

## Transportation Options from the airport to hotel (<http://www.admtl.com/en/access/taxis-limousines>)

- 1) Taxi service: approximately \$40 CAD, flat fee, one way
- 2) Limousine service: approximately \$55 CAD + taxes, one way

Be sure to ask the driver for the fixed rate to downtown. Warning: If they turn on the meter, they may expect you to pay that instead at the end of the trip. Just check to be sure that the meter is off.

Taxis are now required by law to accommodate electronic payments. This may sound funny, but some taxi drivers may still refuse anything but cash, so be sure to check when you get in that payment by credit card is ok. They are also not allowed to ask for any additional fees for accepting an electronic payment.

- 3) Public transportation: **Express bus 747** - \$10 CAD, one way, includes a 24hr pass on the metro system (STM)

The 747 bus runs 24 hr per day on a set schedule between the airport and the bus station downtown, with a number of stops along the route. If there are just one or two of you and don't mind a short walk when you arrive at the right stop, this is certainly the cheaper of the travel options.

The map of the 747 route is on the inside sides of the bus above the windows, and lists all the hotels and the recommended stations for each one. **Rue Peel is the correct stop for the Omni.**



Follow the signs hanging on the ceiling, or the ones all over the floor to where the 747 bus stop is. There are automated machines close to the door to outside for buying the 747 pass. The STM (Montreal's public transit system) has a booth at the airport with people to help visitors pick the right fare and help them with any questions, using the STM machines, etc.

## Transportation options at the hotel

- Car rental: available through hotel concierge service
- 3-minute walk to the [Montreal Metro System](#) (Peel station)





# 2017 – Planned Training Schedule

		SATURDAY			SUNDAY			MONDAY		TUESDAY		WEDNESDAY			
		5/20/2017	5/20/2017	5/20/2017	5/21/2017	5/21/2017	5/21/2017	5/22/2017	5/22/2017	5/23/2017	5/23/2017	5/24/2017	5/24/2017	5/24/2017	
M o n t r e a l	2 0 1 7	Ship Inclining	SAWE RP-7 Mass Properties Management and Control of Military Aircraft	Mass Properties Measurement	Airline Operations	Aircraft Weight Estimating and Use of SAWE RP-8 Weight and Balance Reporting Forms for Military Aircraft	Principles of Weight Management and Weight estimating Methods for the Offshore Oil Industry	A/C Wt and Balance Day 1	Introduction to Aircraft Weight Engineering – based on the textbook - Part 1 of 2	A/C Wt and Balance Day 2	Introduction to Aircraft Weight Engineering – based on the textbook - Part 2 of 2	Automated Weight and Balance Software (AWBS) Training	Advanced Mass Properties Measurement	Aircraft System Optimization - Aircraft Structural Optimization	
		Bill Fox	Paul Kachurak	Wayne Clay	Patrick Brown	Paul Kachurak	Andy Schuster	Tom Oole	Jerry Pierson	Tom Oole	Jerry Pierson	Harold Smoot	Paul Kennedy	Jerry Pierson	
		full day	full day	full day	full day	full day	full day	full day	full day	full day	full day	full day	full day	full day	full day
		Classroom	HIVER/OFFSITE	ÉTÉ	LA GALERIE	PRINTEMPS	ÉTÉ	HIVER	PRINTEMPS	SAISONS A	OFFSITE	SAISONS A	PRINTEMPS	LA GALERIE	SAISONS A
Capacity		25	25	25	25	15	40	60		60	40	40	60		
								OR			OR				
								Aircraft System Optimization			Aircraft Structure Optimization				
								Jerry Pierson			Jerry Pierson				
								1/2 day			1/2 day				

L E G E N D	Courses that have been offered before and are suggested by the Training VP
	New courses that will need acceptance from the Training VP
	New courses that are being planned for the Denver conference this year and could be offered based on feedback by the attendees



# 2016 Fall Regional – Planned Training Schedule

		FRIDAY	SATURDAY	
M o n t r e a l	2 0 1 6	11/4/2016	11/5/2016	11/5/2016
		Airline Operations	Aircraft Fuel Calibration Process	Certifying Weight Engineers to Weigh Aircraft
		Patrick Brown	Jerry Pierson	Jerry Pierson
		full day	1/2 day	1/2 day
Classroom	HIVER	AUTOMNE	HIVER	
Capacity	15	10	10	
		OR	OR	
		Aircraft System Optimization	Aircraft Structure Optimization	
		Jerry Pierson	Jerry Pierson	
		1/2 day	1/2 day	

## Next steps:

- *Confirm instructor availability*
- *Ensure proper room size*
- *Secure aircraft/boat for spring conference*
- *Create a back-up list*





# Technical Papers

- Call for papers (to Canada Chapter members) sent on Feb.12, 2016
  - *2 responses received so far – intentions to submit (3 papers)*
  - *Encouraging more submissions or resubmissions of previous chapter presentations*
- Contact list finalized for major universities in Montreal/Toronto area (ref: table below)
  - *Some initial contacts made by e-mail/telephone conversations*
  - *Official invitations to be sent out early September – should this come for International SAWE office?*
- SAWE invitation to all members
  - *Suggest that this go out in September as well (to support Regional & International)*

University	Contact Name	Phone#	Ext#	e-mail
Ecole Polytechnique de Montreal	Aouni A. Lakis	514-340-4711	4906	<a href="mailto:iicap@polymtl.ca">iicap@polymtl.ca</a>
Ecole de Technologie Superieure (ETS) - Aeroets	Melissa Fafard	514-396-8464		<a href="mailto:melissa.fafard@etsmtl.ca">melissa.fafard@etsmtl.ca</a>
Ecole National d'Aerotechnique (ENA)	Sylvain Lambert	450-678-3561	4235	<a href="mailto:dir.ena@cegepmontpetit.ca">dir.ena@cegepmontpetit.ca</a>
McGill Institute for Aerospace Engineering	Linda Chernabrow	514-398-8664		<a href="mailto:aerospace.engineering@mcgill.ca">aerospace.engineering@mcgill.ca</a>
McGill University - Industry Liaison Manager	<b>Katya Marc</b>	514-398-3355		<a href="mailto:katya.marc@mcgill.ca">katya.marc@mcgill.ca</a>
Universite Concordia - Concordia Institute of Aerospace Design & Innovation (CIADI)	Robert Fewes	514-848-2424	3313	<a href="mailto:fews@encs.concordia.ca">fews@encs.concordia.ca</a>
Universite de Sherbrooke	Hachimi Fellouah	819-821-8000	65641	<a href="mailto:infogme@usherbrooke.ca">infogme@usherbrooke.ca</a>
Universite Laval	Augustin Gakwaya	418-656-2131	5548	<a href="mailto:info@ulaval.ca">info@ulaval.ca</a>
Carleton University	Metin I. Yaras	613-520-2600	1174	<a href="mailto:Metin.Yaras@carleton.ca">Metin.Yaras@carleton.ca</a>
Ryerson University	Joon Chung	416-979-5000	7213	<a href="mailto:j3chung@ryerson.ca">j3chung@ryerson.ca</a>
	Zouheir Fawaz	416-979-5000		<a href="mailto:zfawaz@ryerson.ca">zfawaz@ryerson.ca</a>
University of Toronto	D. W. Zingg	416 667-7717		<a href="mailto:dwz@oddjob.utias.utoronto.ca">dwz@oddjob.utias.utoronto.ca</a>
University of Waterloo	Paul Fieguth	519-888-4567	84970	<a href="mailto:sydechair@uwaterloo.ca">sydechair@uwaterloo.ca</a>
York University	Regina S.K. Lee	416-736-2100	77757	<a href="mailto:reginal@yorku.ca">reginal@yorku.ca</a> , <a href="mailto:essechr@yorku.ca">essechr@yorku.ca</a>

# Sponsors & Vendors

- **Sponsors** – following companies are being contacted this year to participate and/or sponsor our upcoming conferences.
- **Vendors** – no vendors have been approached yet

Aerospace Company	Contact Name	Phone#	Ext#	e-mail
Bell Helicopter Textron Canada	Raymond Leduc	450-971-6500		
Bombardier Aerospace	Christina Peikert	514-855-7989		
CAE	Helene V. Gagnon	514-340-5536		<a href="mailto:helene.v.gagnon@cae.com">helene.v.gagnon@cae.com</a>
C&D Zodiac	Michel Bussey	514-697-5555		
Heroux-Devtek	Jean Gravel	450-679-5450	4227	<a href="mailto:jgravel@herouxdevtek.com">jgravel@herouxdevtek.com</a>
L-3 MAS	Paul Mercier	450-476-4719		<a href="mailto:info.marketing@l-3com.com">info.marketing@l-3com.com</a>
Messier-Bugatti-Dowty (Safran)	Bryan Teed	905-683-3100	1280	<a href="mailto:bryan.teed@safranmbd.com">bryan.teed@safranmbd.com</a>
National Research Council Canada (NRC) - Montreal	Matthew Tobin	613-990-0765		<a href="mailto:matthew.tobin@nrc-cnrc.gc.ca">matthew.tobin@nrc-cnrc.gc.ca</a>
Pratt & Whitney Canada	Marilena Sarli	450-677-9411		<a href="mailto:pwc.contributions@pwc.ca">pwc.contributions@pwc.ca</a>
Rolls-Royce Canada	Lee Fromson	514-631-3541		<a href="mailto:Rolls-RoyceCanadaCommunications@Rolls-Royce.com">Rolls-RoyceCanadaCommunications@Rolls-Royce.com</a>
Stelia Aerospace North America	Charlotte Mommaton	450-595-8382		<a href="mailto:charlotte.mommaton@stelia-aerospace.com">charlotte.mommaton@stelia-aerospace.com</a>
Thales Canada, Aeronautique	Michel Grenier	514-832-0900		<a href="mailto:contact.info@ca.thalesgroup.com">contact.info@ca.thalesgroup.com</a>
UTC				

Shipbuilding Company	Contact Name	Phone#	Ext#	e-mail
A.F. Theriault & Son Ltd.	Michael Mason	902.645.2327		<a href="mailto:info@aftheriault.com">info@aftheriault.com</a>
Chantier Davie Canada Inc.	Guyline Simoneau	418-837-5841		<a href="mailto:guyline.simoneau@davie.ca">guyline.simoneau@davie.ca</a>
Chantier Naval Forillon Inc	Sylvaine Minville	418-368-6035	207	<a href="mailto:sylvaine@chantier-naval.com">sylvaine@chantier-naval.com</a>
Fleetway Inc. (Irving Shipbuilding)	Peter McMillan	613-236-6048		<a href="mailto:McMillan.Peter@fleetway.ca">McMillan.Peter@fleetway.ca</a>
Robert Allan Ltd., Naval Architects		604-736-9466		<a href="mailto:info@ral.ca">info@ral.ca</a>

Associations	Contact Name	Phone#	Ext#	e-mail
AERO MONTREAL	Pierrette Daigle	514-987-9332		<a href="mailto:pierrette.daigle@aeromontreal.ca">pierrette.daigle@aeromontreal.ca</a>
MONTREAL INTERNATIONAL	Louis Arseneault	514-987-9376		<a href="mailto:louis.arseneault@mtlintl.com">louis.arseneault@mtlintl.com</a>
CARGO MONTREAL	Mathieu Charbonneau	514-508-2609 x222		<a href="mailto:mcharbonneau@cargo-montreal.ca">mcharbonneau@cargo-montreal.ca</a>
IATA (International Air Transport Association)	Mike Huntington			<a href="mailto:Huntingtonm@iata.org">Huntingtonm@iata.org</a>

- **Current list of company members, annual sponsors --- who confirms their participation?**





## Potential Social Events

Cirque du Soleil (*Sun, Tues*)

<https://www.cirquedusoleil.com/canada/montreal/shows>

Montreal City Hop-On-Hop-Off (*Mon, Tues, Wed*)

[http://www.grayline.com/tours/montreal/hop-on-hop-off-double-decker-tour-red-loop-5867\\_2](http://www.grayline.com/tours/montreal/hop-on-hop-off-double-decker-tour-red-loop-5867_2)

Old Montreal Guided Walking Tours (*Mon, Tues, Wed*)

<http://guidatour.qc.ca/en/tours-for-groups/on-foot-private-walking-tours/old-montreal/>

<http://www.lonelyplanet.com/canada/montreal/activities/food-drink/flavors-old-montreal-walking-tour>

Rafting Montreal – Lachine Rapids (*Mon, Tues, Wed*)

<http://raftingmontreal.com/en/rafting-jet-boating-downtown-montreal/>

Canadian Aviation Heritage Centre (CAHC) (*morning Mon, Tues*)

<http://www.cahc-ccpa.com/en/>

Denis Charbonneau Orchard & Cidery (*Mon, Tues, Wed*)

<http://vergersdc.qc.ca/en/>

Bombardier C-Series Tour - Mirabel (Thursday)



# Cirque du Soleil



## ***Old Montreal location – “Grand Chapiteau”***

- a mind-blowing experience of sight and sound; a re-invention of the circus*
- prices range from \$44 to \$195 depending on seat location*
- will follow-up later in the year to confirm chosen date/group pricing*
- no performances on Mondays (target Sunday May 21, or Tuesday May 23)*
- will require shuttle/bus service*

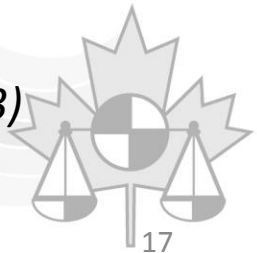



# Montreal City Hop-on Hop-off Tour

- *Entertaining and educational hop-on hop-off bus tour.*
- *Hop on at any of the 10 stops.*
- *London-style double-decker buses*
- *Anytime between 10am and 4pm*

Enjoy the view with a live commentary of interesting facts and stories from an expert guide who knows this historic city inside and out. Learn about the past, present and future of Montreal, the largest city in Quebec, as the bus rolls along from one location to the next. Hop off at any of the attractions for a closer look, then hop back on when it's convenient.

Visit popular sites like **Notre-Dame Basilica**, **Chinatown**, **Crescent Street**, **Dorchester Square**, **Old Montreal**, **Old Port**, **Mount Royal Park** and much more. It truly is a fun and fast way to get to know the city of Montreal and the many amazing attractions it offers. A sightseeing tour of Montreal has never been easier — or more fun — than this hop-on hop-off tour of the city. Experience Montreal in this unique way.

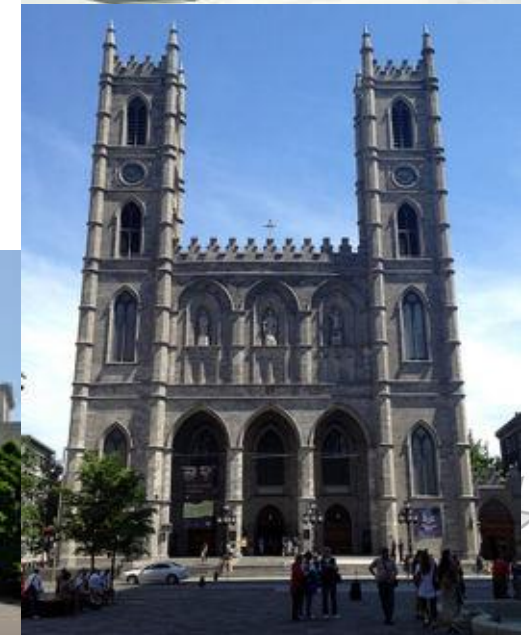

## Rafting Montreal



*Get ready for a ride of a lifetime aboard our famous Jet Boats, or brave the Rapids in a Raft, a wet and action filled adventure on the Lachine Rapids for all ages. A super outing for the whole gang! Just minutes from downtown Montreal !*

- ✓ *Great location*
- ✓ *Choice of rafting or jet boat*
- ✓ *Excellent group rates*



Interested in offering one of their boats for ship inclination course !



## Bombardier C Series Tour at Mirabel



### ***Guided tour of the Bombardier C series final assembly plant – at Mirabel***

*Issues to coordinate:*

- *Busing to and from hotel*
- *Security clearances/checks*
- *May be difficult to organize during the work week (planned date is Thurs, May 25)*
- *Bombardier support “to be confirmed”*
- *\$Cost*





# Conference Planning – Key Tasks for 2016

- **Promotion –**

- Continue to promote our conferences to Engineering Universities, goal is to get significant number of **technical papers** submissions from the Montreal area
- Continue making contacts with various corporations, encouraging **participation and/or sponsorships**
- Generate excitement in members' places of employment, "spreading the word"....
- **Advertise** at 2016 conference in Denver
- "Official" notices start in September for Regional Conference

- **Organization –**

- Continue monthly planning meetings, **burn down actions from Ops Manual**, get reports from each coordinator
- **Delegate activities**, ensure every coordinator is fully aware of responsibilities and support
- Move from brainstorming to **decision making** – Chairmen responsibility, SAWE Executive support
  - Social events, training plans, budget, guest speakers, etc.

- **Finances –**

- Set-up conference **bank account – US dollar**
- Ensure **hotel deposits** are made
- Create **budget for both regional and international** conferences

- **Feedback –**

- **Communicate well with SAWE international board**, be open to further ideas, use as a "sounding board" in making final decisions
- **Create contacts** at Denver Conference to understand level of support

